

## **CITY CENTER WEST COMMERCIAL METROPOLITAN DISTRICT**

141 Union Boulevard, Suite 150  
Lakewood, Colorado 80228-1898  
Tel: (303) 987-0835 or (800) 741-3254  
Fax: (303) 987-2032

December 28, 2020

Division of Local Government  
1313 Sherman Street, Room 521  
Denver, Colorado 80203

[DLG E-Portal](#)

Weld County Assessor  
Attn: Dee Kayl  
1400 North 17th Avenue  
Greeley, Colorado 80631

[dkayl@weldgov.com](mailto:dkayl@weldgov.com)

Weld County Clerk and Recorder  
1402 North 17th Avenue  
Greeley, Colorado 80631

[weld-districts@weldgov.com](mailto:weld-districts@weldgov.com)

Re: CITY CENTER WEST COMMERCIAL METROPOLITAN DISTRICT

Ladies and Gentlemen:

In accordance with Section 32-1-306, C.R.S., as amended, attached is a current map of the boundaries of the above-referenced district in PDF format.

If I can be of further assistance, please contact me.

Sincerely,

Alysia Padilla  
Assistant to Ann E. Finn  
District Manager

cc: McGeady Becher P.C. – Catherine Will



**City Center West  
Commercial  
Metropolitan District  
45.219 Acres**

**City Center West  
Commercial  
Metropolitan District  
7.813 Acres**

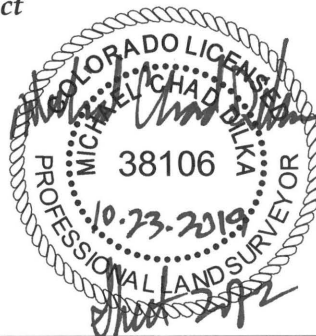

Michael Chad Dilka – On Behalf Of King Surveyors  
Colorado Licensed Professional Land Surveyor #38106

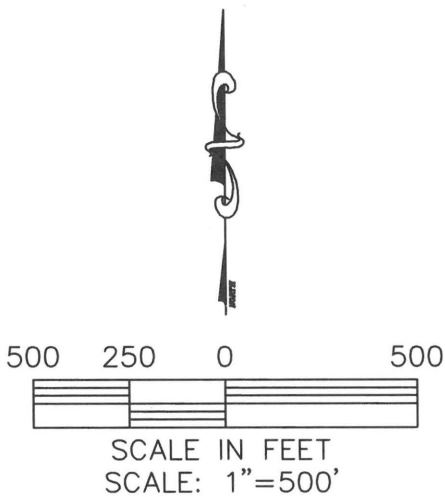

REFERENCE DOCUMENTS		
Record Date	Reception No.	Description
04/17/2008	3548341	Order and Decree to Create District
09/07/2011	3790531	Order for Exclusion
06/04/2014	4020821	Order for Inclusion
12/03/2014	4065878	Order for Exclusion

NOTE: This exhibit drawing is not intended to be a monumented land survey. Its sole purpose is as a graphic representation to aid in the visualization of the written property description which it accompanies. The written property description supersedes the exhibit drawing.

NOTICE: According to Colorado law you must commence any legal action based upon any defect in this survey within three years after you first discover such defect. In no event may any action based upon any defect in this survey be commenced more than ten years from the date of the certification shown hereon. (13-80-105 C.R.S. 2012)



**KING SURVEYORS**

650 E. Garden Drive | Windsor, Colorado 80550  
phone: (970) 686-5011 | fax: (970) 686-5821  
email: contact@KingSurveyors.com

PROJECT NO:20190631  
DATE: 10/23/2019  
CLIENT: WESTSIDE INVESTMENT  
DWG: 20190631EXH-METRO  
DRAWN: CSK CHECKED: MCD